

la  illette

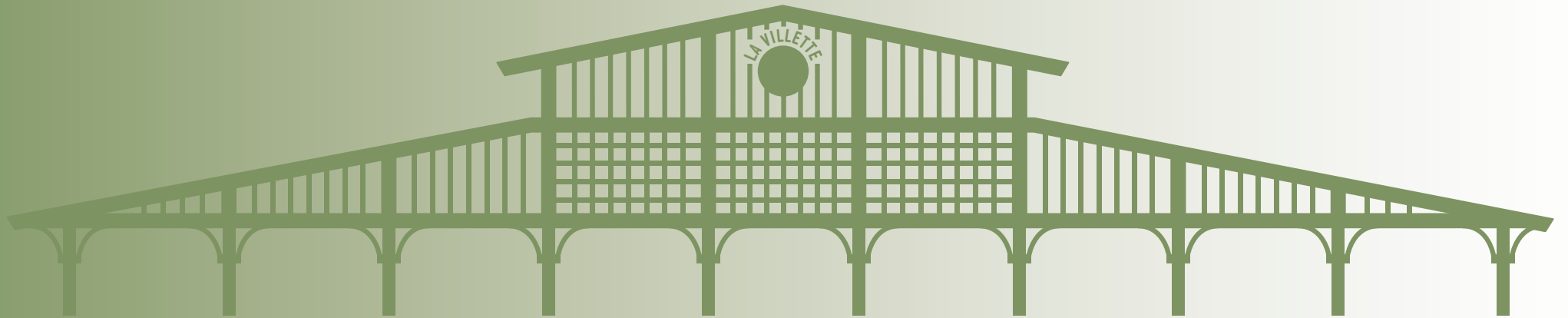

**Your Events
at La Villette**



La Villette is more than just a park

La Villette is a veritable green lung in the heart of Paris. Its 55 hectares make it Europe's largest urban cultural park.

Designed by Bernard Tschumi, it comprises meadows, gardens, and buildings that fulfill its mission of hosting cultural, educational, and athletic activities and events.

Between its open-air spaces and singular architectural constructions, such as La Grande Halle, the variety of spaces in Parc de la Villette can meet all of your event planning needs.

The presence of other institutions at the site, such as the Paris Philharmonic, the Paris National Conservatory of Music and Dance, Le Théâtre de Paris, the Zénith, Le Trabendo, Le Cabaret Sauvage, and Universcience, makes the park a premier destination – as well as the perfect place for your multi-site events.

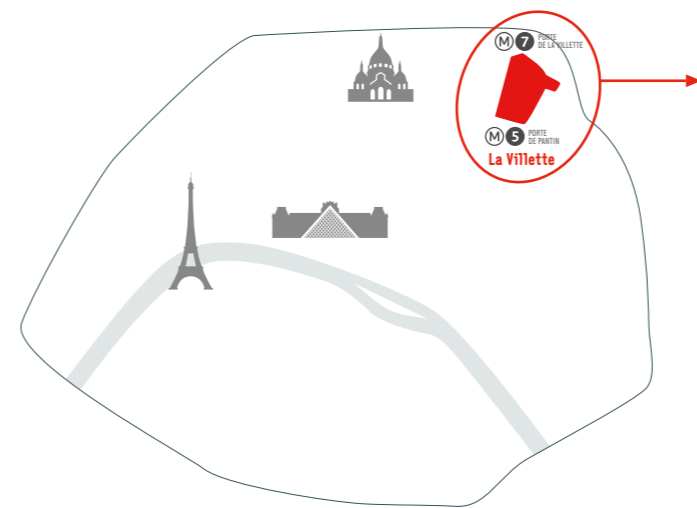

- 1 Place de la fontaine-aux-lions de Nubie
- 2 Grande Halle
- 3 Prairie du triangle
- 4 Prairie du cercle sud
- 5 Prairie du cercle nord
- 6 Espace Chapiteaux
- 7 Le Périphérique
- 8 Folie des fêtes
- 9 Folie belvédère
- 10 Folie douce



La Grande Halle

15,690 m² adaptable to all your needs

With a ceiling height of between 13 and 17 metres, La Grande Halle is one of the most beautiful examples of nineteenth-century iron and glass architecture anywhere. It has been a registered historic monument since 1979.

With its modern and instantly recognisable design, it rises majestically at the southern entrance to the Parc de la Villette.

La Grande Halle's 15,690 m² are an invitation to design highly memorable experiences, providing the ideal setting for your most important events.

With 8,675 m² of space on the ground floor, La Grande Halle also has partitioned areas along the sides called "studios", as well as balconies that overlook the entire space. Three movable platforms of 200 m² each connect the balconies, creating ample elevated space for staging and expanding the available footprint (ground floor + upper level). Technical gantries allow for the suspension of heavy loads and a creative engagement with the venue's aerial architecture.

La Grande Halle can also be split into two areas by using a mobile tympanum with a sound insulation of 40 dB: the Nave and the Espace Charlie Parker.

The Boris Vian Auditorium is the perfect space to host lectures and conferences. It is directly accessible from either the Nave or using separate entrances.

Lastly, outdoor spaces such as the Peristyle, the East Gallery, and the Place du Charolais provide additional modular options to help you stage your event.

The spaces within La Grande Halle



NEF

Surface area	Characteristics	Capacity, depending on the format
<ul style="list-style-type: none"> • Total surface area: 9,214 m² • Surface area, ground level (incl. the atrium): 6,130 m² • 6 balconies: 2,140 m² • 2 studios: 590 m² • 1 catering space: 364 m² • Reception area: 700 m² with a fixed reception desk 	<ul style="list-style-type: none"> • 1 studio transformed into a catering space that can be used as a workshop or kitchen space • Can be fully blocked off • Restrooms located on the lower level • Ground-level access • Oak flooring and sandstone paving around the edges 	<ul style="list-style-type: none"> • Cocktail: 7,000 individuals • Sit-down dinner: 3,800 individuals • Conference: 4,400 individuals • Conference & cocktail: 5,700 individuals

CHARLIE PARKER

Surface area	Characteristics	Capacity, depending on the format
<ul style="list-style-type: none"> • Total surface area: 4,550 m² • Surface area ground level: 3,595 m² • 2 balconies: 495 m² • 2 studios: 460 m² • Reception area: 350 m², unfurnished 	<ul style="list-style-type: none"> • 1 studio transformed into a catering space that can be used as a workshop or kitchen space • Can be fully blocked off • Restrooms located on the lower level • Ground-level access • Oak flooring and sandstone paving around the edges 	<ul style="list-style-type: none"> • Cocktail: 2,650 individuals • Sit-down dinner: 1,300 individuals • Conference: 2,050 individuals • Runway show: 1,000 individuals

BORIS VIAN AUDITORIUM (LOWER LEVEL)

Surface area

- Auditorium with tiered seating
- Adjoining 140 m² foyer-bar
- Separate entrance available

Technical information

- Fully equipped with a sound, lighting, video, and cinema projection control suite, including a 9.4 m × 4.3 m trans-sonorous rear-projection screen, with a default projection size of 8 m × 4 m.
- 14 m × 9 m stage
- 2 dressing rooms

Capacity, depending on the format

- 296 seats, 6 of which are accessible for persons with reduced mobility (PRM)

TECHNICAL INFORMATION

- **Electrical power:** 380 V three-phase power, 52 distribution panels ranging from 32 to 400 A, 96 sockets ranging from 16 to 63 A
- **Technical gantries:** 4 mobile gantries (13.5 m in height, 26.3 m in length, and 8 m in width) able to sustain a load of 40 tonnes each
- **Stage platforms:** 3 platforms of 200 m² each situated 4.35 m off the ground, used to connect the balconies
- **Maximum floor load:** 900 kg/m²
- **PRM accessibility** on all levels of the building
- **Gable facades** on the north and south sides, each opening 26 m wide, offer ground-level access for loading and unloading
- **2 sliding doors** (3.8 m in height, 3.25 m in width) for loading and unloading
- **8 lifts**, maximum load: 1 tonne



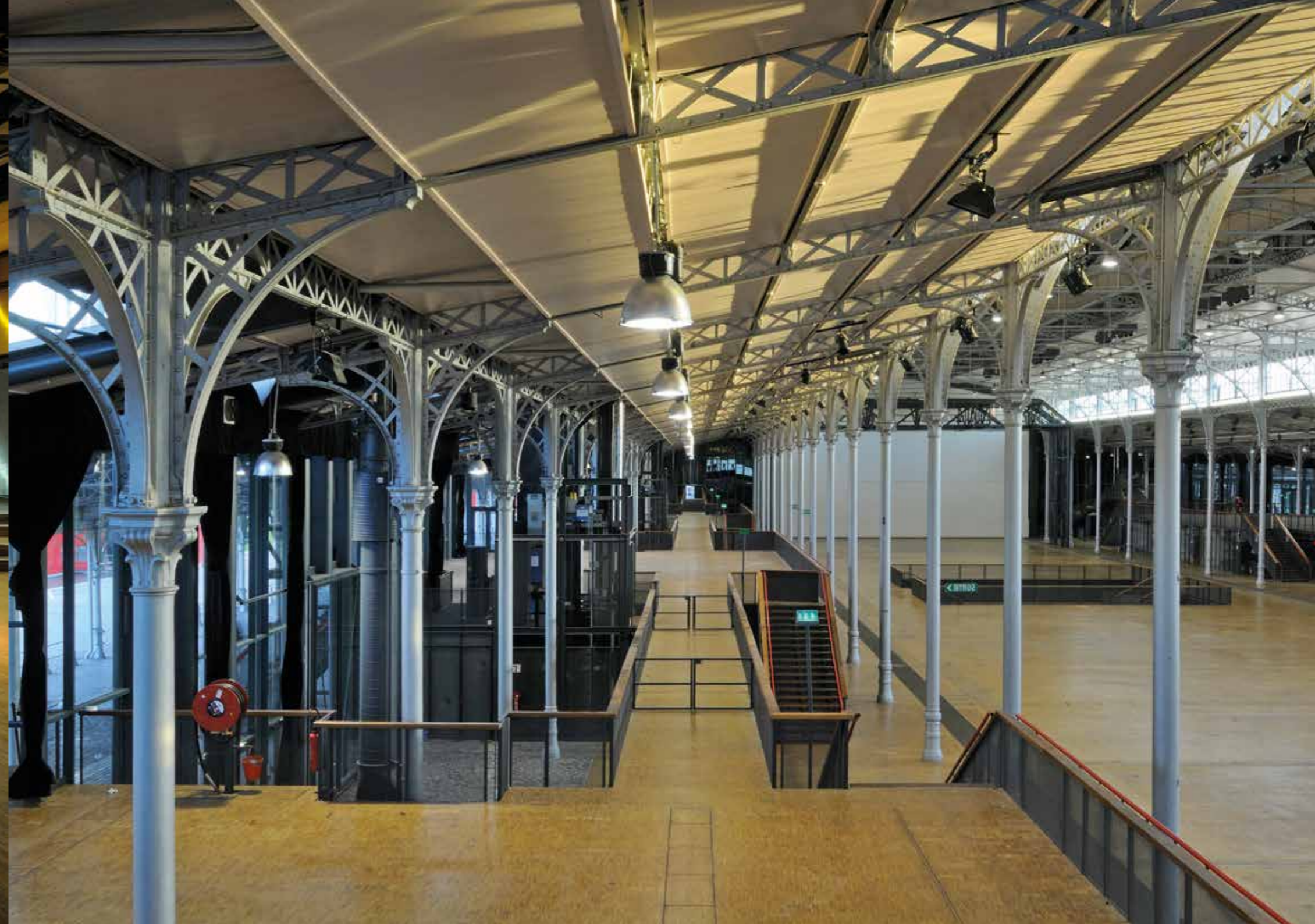

Espace Chapiteaux

6,300 m² of open-air space in Paris

L'Espace Chapiteaux is an iconic cultural and artistic site situated in the heart of Le Parc de la Villette. It hosts a broad diversity of events, from performances to exhibitions, immersive experiences, and more. Its 2,000 m² modular structure provides a unique, inspiring setting for creative and immersive experiences.

Since 2023, Espace Chapiteaux has been welcoming more and more event organisers and exhibition producers. The remarkable success of the *Tim Burton* immersive experience, which drew more than 240,000 visitors, provides just one example of the site's ability to host major projects that make a lasting impression on visitors.

L'Espace Chapiteaux is available for your exhibitions and immersive experiences from February to September.

TECHNICAL SPECIFICATIONS

- 3,800 m² of secure, open-air space
- A production office (appr. 15 m²)
 - Public restrooms
- Main structure of 2,000 m² net, installable
- A ticketing area, the Folie Kiosque (L4), with a 2,500 m² forecourt
- A F&B container can be installed, including a public terrace



Le Périphérique

A unique site

An unusual site nestled beneath Paris' ring road, Le Périphérique is an atypical space with an underground spirit. It is open for all kinds of events, from concerts to soirées, exhibitions, performances, and runway shows.

With its 1,500 m² of open-air space, landscaped tiered seating, and two alcoves (one of which is equipped with a stage and a grill), Le Périphérique was designed with your needs in mind. With a standing-room capacity of up to 3,500 people for concerts, this unusual space is perfect for innovative productions.

Unleash your creativity in this extraordinary setting!



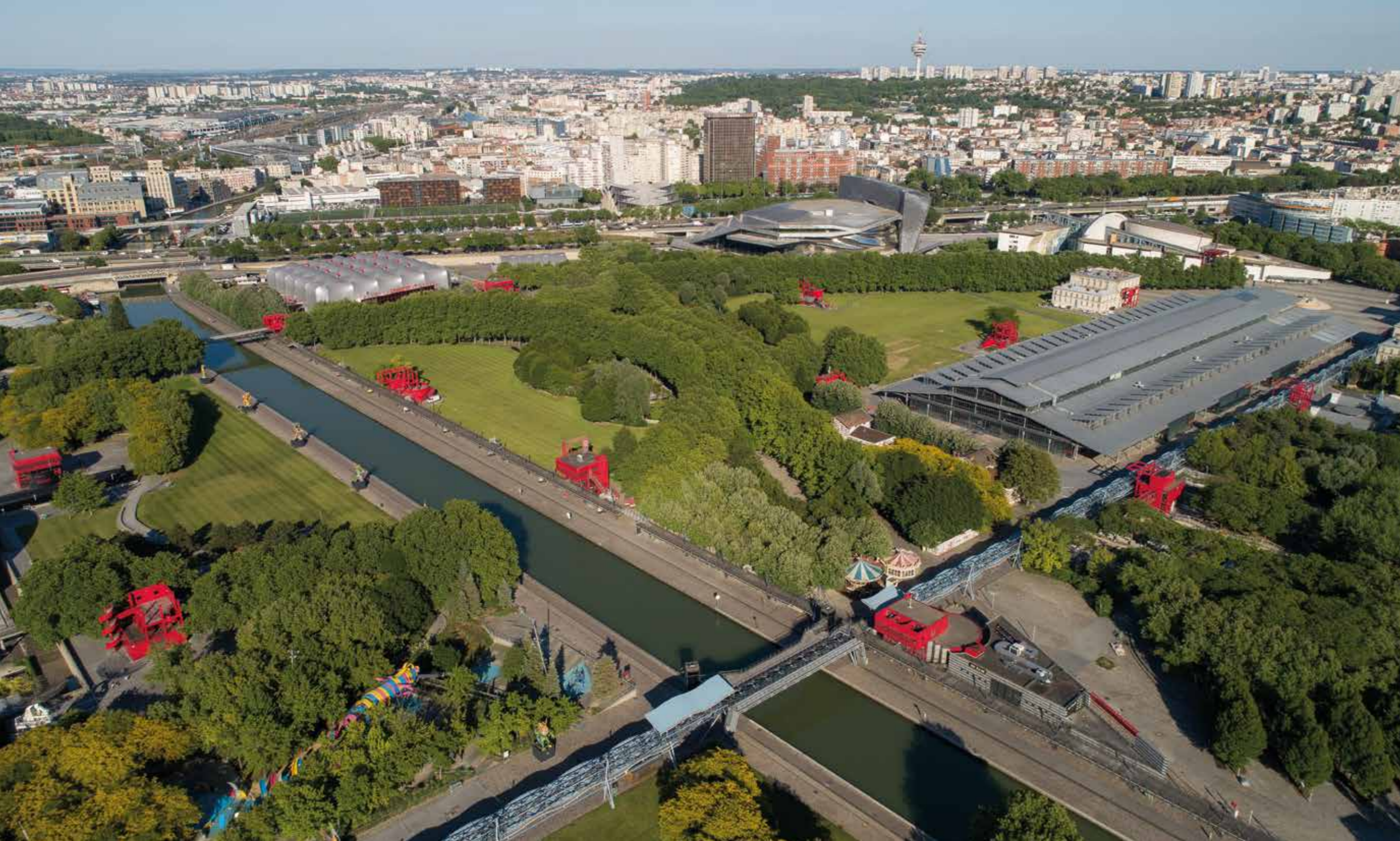

The outdoor spaces

A vast playground

As Paris' largest landscaped park and Europe's largest urban park, Le Parc de la Villette offers a unique combination of nature, architecture, culture, and leisure activities. It welcomes 12 million visitors each year from around the world to its highly original 55 hectares, which comprise 35 green spaces. There are plenty of open-air spaces available for your promotional events, temporary installations, and team-building activities!

Recognisable by their red colour, Bernard Tschumi's 26 Folies have become the main symbol of the Park. These architectural works punctuate its large grass meadows and mineral areas. Some can be made available in conjunction with your rental of the Grande Halle or the open-air spaces.

Make your projects truly extraordinary by choosing La Villette for your exceptional events!

Place de la Fontaine aux Lions-de-Nubie

8,000 m²

Situated at the southern entrance to the Park, La Fontaine aux Lions-de-Nubie is a major waypoint for reaching the Park's main sites, including La Grande Halle de la Villette, the Paris Philharmonic, Le Zénith, Le Théâtre Paris-Villette, Le Trabendo, and Le Hall de la Chanson. With more than 8,000 m² of space, this place's unique combination of heritage and modernity provides the ideal setting for your events.



Prairie du Triangle

20,000 m²

The main meadow for large gatherings in the good-weather months, such as the Open-Air Cinema, La Prairie du Triangle is situated at the Park's entrance between La Grande Halle and the Paris Philharmonic. This green space can host your events or serve as an extension for your events held within La Grande Halle. At 20,000 m², La Prairie du Triangle is Paris' largest meadow.



Prairie du Cercle

La Prairie du Cercle is located in the middle of Le Parc de la Villette, along Le Canal de l'Ourcq. You can admire this stunning circular meadow from the various walkways, ranging from its calm, landscaped setting to the south to its more urban ambiance to the north, with La Géode and La Cité des Sciences as its backdrop. Le Canal de l'Ourcq cuts through the middle of this meadow.



Prairie du Cercle (north) 9,900 m²

Prairie du Cercle (south) 12,600 m²



Folie des Fêtes N6

Exterior: 2,880 m² + Interior: 230 m²



This folie facing the Hall de la Chanson is home to Ateliers Villette and the cultural mediation facilities. It can also be rented as a complement to an outdoor space, pending its availability. It features a large, round room with many windows and a terrace with a spectacular view of the Park. Urban furnishings designed by Starck welcome you in its lobby.

Folie Belvédère P6

Forecourt of 2,000 m²



At the intersection of La Prairie du Cercle and La Prairie du Triangle, this folie is instantly recognisable for its ramp and spiral staircase. Its terraces offer a beautiful panoramic point over the Park.

Folie Douce N7

Exterior: 500 m² + Interior: 95 m²



Looking out onto La Grande Halle and La Prairie du Triangle, this folie features a ground floor room and a terrace overlooking the meadows and the Paris Philharmonic.

Filming

Set your stories at La Villette!

With its **55 hectares of unique settings** combining nature, contemporary architecture, and iconic spaces, Le Parc de la Villette is the ideal place for your film projects set in the heart of Paris. Whether for a film, TV show, commercial, photo shoot, or music video, La Villette provides a diverse array of spaces that are perfect for any type of shoot.

Give your scenes the charm, modernity, and originality of a setting that draws millions of visitors every year.

We remain available to assist you with your request.



Large-scale exhibitions

In the Grande Halle: the Southern Nave

For several months each year, a wall is installed to separate the Nave into two parts.

At approximately 3,000 m² in size, the Southern Nave can host a major exhibition within a space that is generally articulated in the following manner:

- a monumental entrance through the peristyle
- a studio (a closed space to the side) for the ticketing office and workspace for the exhibition team
- four balconies overlooking the space
- a mobile platform that can be installed between two balconies to connect them and increase the surface area of the upper floor

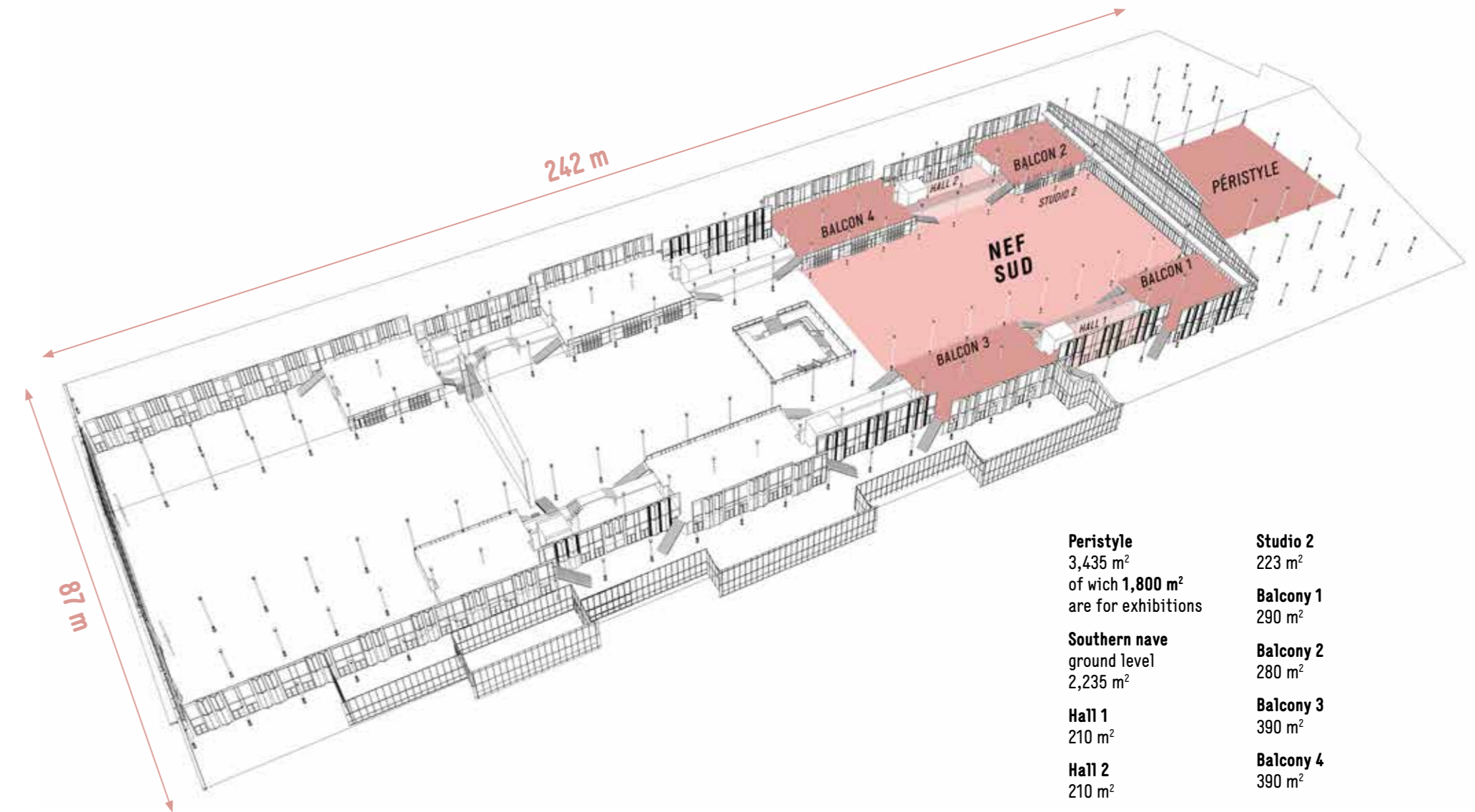

Our major exhibitions



TUTANKHAMEN : THE PHAROAH'S TREASURES

2019

An exhibition and event to celebrate the centenary of Howard Carter's discovery of Tutankhamen's treasure, featuring 150 of the extraordinary objects found in the tomb, as well as an immersive experience.

1,470,200
visitors



NAPOLEON

2021

On the occasion of the bicentenary of Napoleon's death, a spectacular exhibition that furnishes an accurate and unflinching portrait of a fascinating character who shaped modern France.

309,000
visitors



POP AIR

2022

Monumental, immersive, and entertaining works by more than fifteen international artists brought together in an innovative, customised format hosting art, artists, and the public.

723,000
visitors



RAMSES AND THE GOLD OF THE PHAROHS

2023

More than 180 original works in an immersive environment plunge visitors into the heart of the fabulous temple of Abu Simbel and the Tomb of Nefertiti!

820,000
visitors

They chose La Villette

Nations Park

LA VILLETTE - NATIONS PARK

2024

1,600,000

visitors



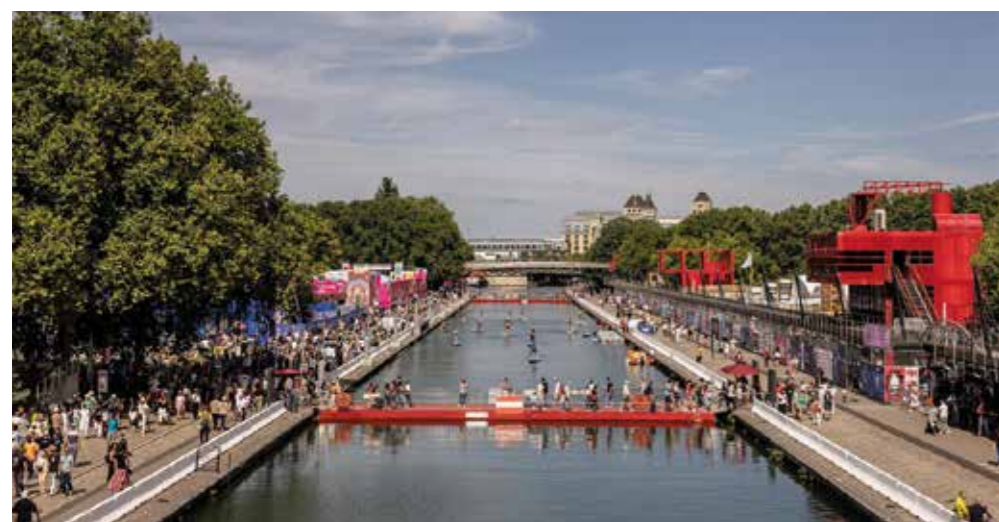





One of the highlights of the summer of 2024 was the Paris 2024 Olympic and Paralympic Games. For this occasion, the Park became **La Villette-Nations Park**, hosting 15 countries in a unique space for celebration and international exchange. More than 1.6 million people (visitors, spectators, and delegations) enjoyed this exceptional environment that combined culture, festivities, and a sense of togetherness. Between sports workshops, exhibitions, and a general merriment, Le Parc de la Villette heightened the elation of the Olympic and Paralympic Games.

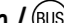

Practical informations

ACCESS

Public transportation

- **Metro:**  5 Porte de Pantin /  7 Porte de la Villette, Corentin Cariou
15 mn. from the Gare du Nord
- **Bus:**  75  151 Porte de Pantin /  139  150  152 Porte de la Villette
- **Tram:**  3b Porte de Pantin, Ella Fitzgerald ou Porte de la Villette

Bicycle

- **Bicycle path:** along the Canal de l'Ourcq
- **Vélib stations:** Porte de la Villette, Porte de Pantin, Quai de Metz, rue Rouvet
- **Bicycle parking:** On the forecourt of the Cité des Sciences, facing the Porte de la Villette

By boat on the canal

- **With Canauxrama:** From or to the Port de l'Arsenal
- **With Paris Canal:** From or to the Musée d'Orsay

Cover illustration and design Estelle Durand • EPPGHV 211 avenue Jean-Jaurès 75019 Paris
RCS Paris B 391 406 956 - Licences 1-1087013 / 2-1087011 / 3-1087009 • EPPGHV/2026.02.02

Page 2 © Stéphane Cantin • Page 4 © Serge Sautereau • Page 9 © Jean-Pierre Delagarde • Page 10 © Jean-Pierre Delagarde • Page 11 © Jean-Pierre Delagarde • Page 13 © Elie Delpit et Louis Didaux • Page 15 © Christophe Raynaud de Lage • Page 16 © Stéphane Cantin • Page 18 © Elie Delpit et Louis Didaux • Page 19 © Flora Métayer • Page 20 © Elie Delpit et Louis Didaux • Page 21 © Julien Hélaïne • Page 22 © Elie Delpit et Louis Didaux • Page 23 © Philippe Levy • Page 24 © Julien Hélaïne • Page 25 © Julien Hélaïne, © Bruno Delamain • Page 26 © Bruno Delamain, © Jean-Pierre Delagarde, © Julien Hélaïne • Page 27 © Bruno Delamain, © Julien Hélaïne, © Bruno Delamain, © DR • Page 30 © Nicolas Krief, © DR • Page 31 © Julien Hélaïne, © Edouard Richard • Page 32 © Renaud Bouchez • Page 33 © Renaud Bouchez • Page 35 © Arnaud Legrain

OUR EVENTS TEAM
IS READY TO HELP YOU

evenementiel@villette.com

lavillette.com/formulaire-location-espace/



la  illette